



PATCO

STEWARDSHIP. SERVICE. COMMUNITY.

FRANKLIN SQUARE STATION REOPENING

PROJECT OVERVIEW

 **PROJECT INVESTMENT:**
\$30 MILLION

 **PROJECT COMPLETION:**
EARLY 2024

PROJECT DESCRIPTION:

The Franklin Square Station is coming back. Since its grand opening in 1936, the station has sporadically closed and reopened with the last passenger service period in the 1970s.

The station will be fully functional and align with the existing thirteen Port Authority Transit Corporation (PATCO) transit stations. The project will address improvements to the station's civil, structural, mechanical, and electrical systems as well as provide access in compliance with the current Americans with Disabilities Act (ADA) standards.

PROJECT GOALS:

- Integrate the station into the existing community and park
- Improve infrastructure
- Phase the construction to reduce impacts to the park
- Provide access and mobility
- Stimulate economic growth and employment opportunities
- Implement sustainable and energy efficient improvements: *green roof, vegetated wall, tree plantings, energy efficient LED light fixtures*
- Serve the community by reducing congestion in the area

CONTACT US:

 info@thefranklinsquarestation.com

 856-567-DRPA (3772)

 www.TheFranklinSquareStation.com



Follow RidePATCO

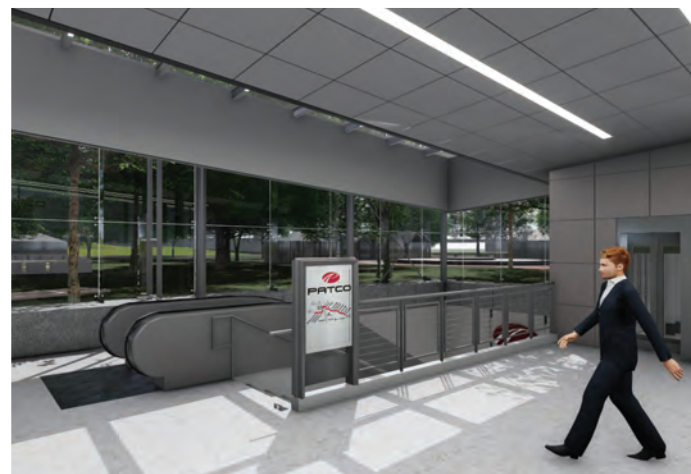

LEARN MORE

Sign up for
project updates
via email

